

ANALOGUE

M201EA-240: Module for 240VAC Loads

Overview

Features

- Integrated DIN rail brackets
- Switching output module
- Tri-colour light pipes
- Built-in short circuit isolators
- CLIP and advanced protocol
- Addressability through rotary switches
- Configurable relay power up position (BSI 7273-4)
- Laser engraved label data
- High power loop 48V ready
- Low standby current
- Common mechanical platform for modules' enclosure
- Improved light pipe visibility on two sides
- IP30 rated
- VdS and CPR approved
- EN 62368-1 certified

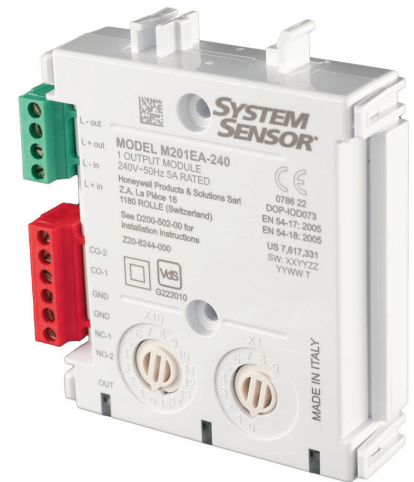

0786 - CPR - 21746

G 222010

Description

The M201EA-240 module is part of the new family of input/output modules in System Sensor Europe's Series 200 plus range.

The M201EA-240 is a loop-powered device controlling an unsupervised double pole (one normally open, one normally closed) output suitable for managing 240VAC loads. The output relay is a bistable device, latching in the On or Off state on command from the control panel.

The module is supplied in new shiny white enclosure common to the whole I/O modules family. This enclosure is equipped with integrated DIN rail brackets, designed to mount directly on to a standard 35mm 'Top Hat' DIN rail.

Each module has built-in short circuit protection for the communications loop; however, to increase application flexibility, the isolators can be selected/deselected on an individual module basis.

To help technicians in the maintenance and fault-finding process, light pipes have been enlarged to increase visibility even in the most challenging space constrained application. Both the status LED and the rotary switch selection can be viewed on the two sides without having to remove the cover of the surface mounting box. The multi-colour status LED, provide diagnostic information regarding the status of each individual input/output.

For ease of installation, testing and maintenance, modules have been equipped with quick connectors. The module mounts a 4+6 terminal blocks: the green color terminal block of 4 works with 24V, while the red colour one of 6 works with 240V.

The renovated aesthetics offer data finely engraved on the enclosure's surface by laser for lifetime durability and resistance to degradation.

Architect/Engineer Specifications

M201EA – 240 Switching Output Module

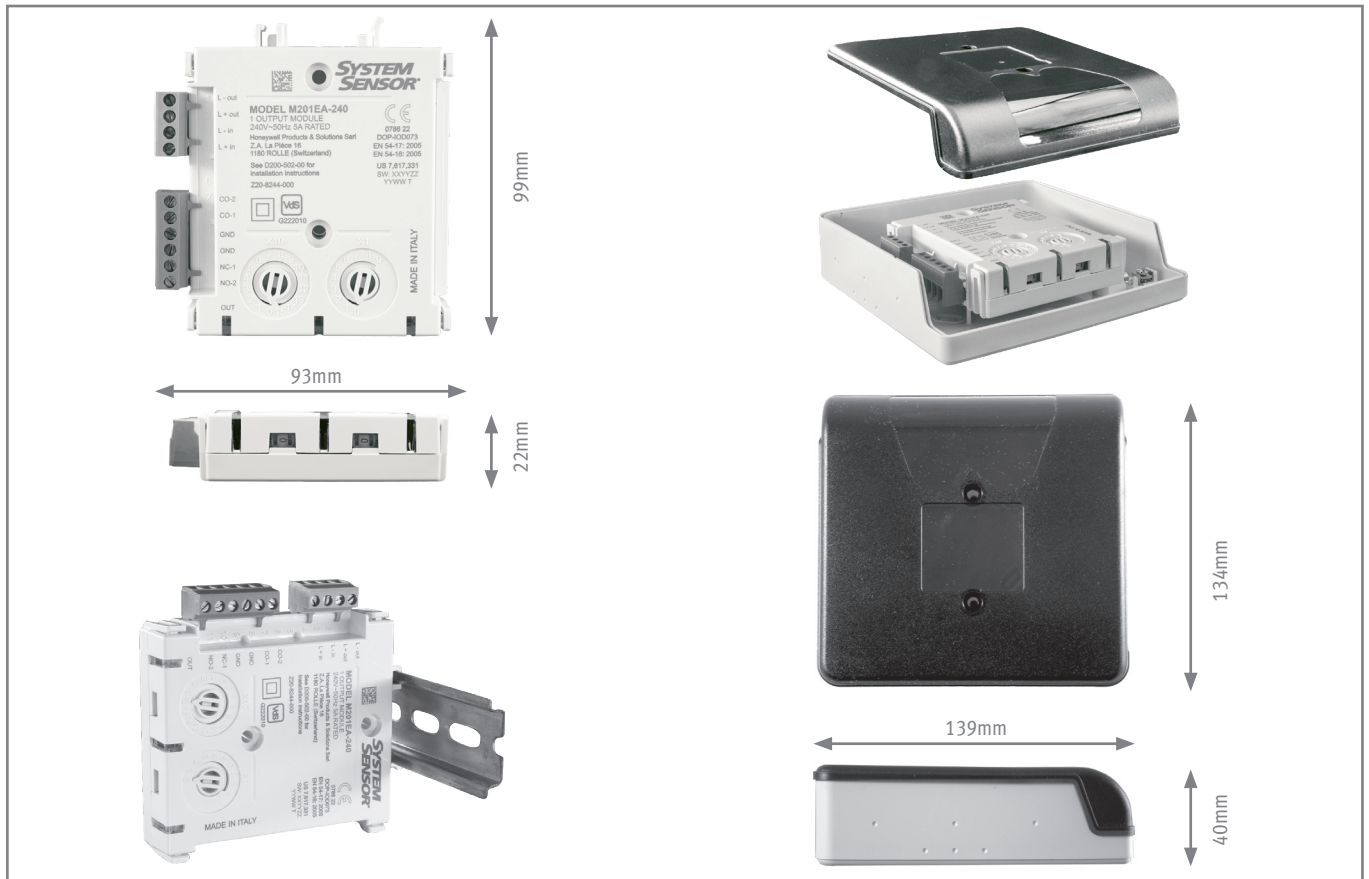

Electrical Specifications

Operating Voltage Range	15 to 32VDC
LED Cutoff Voltage	16.5 VDC
Maximum Standby Current	75µA at 24VDC (no communications)
Maximum Alarm Current	5.5mA at 24VDC, one communication each 5 seconds with LED blink enabled
Coil Activation/Deactivation Current	76mA max for 12mS
Relay Specifications	5A at 30VDC, 5A at 250VAC, resistive load 1 x NO and 1 x NC contacts

Environmental Specifications

Application Temperature Range	-20°C to 60°C
Humidity	5% to 95% Relative Humidity (non-condensing)
IP Rating	IP30 (IP44 in M200E-SMB)

Mechanical Information

Height	22mm
Length	93mm (including terminal blocks)
Width	99mm (including DIN brackets)
Weight	118g
Maximum Wire Gauge for Terminals	2.5mm ²

System Sensor (Technical Services)

System Sensor Europe
 Email: sse.technical@systemsensor.com
www.systemsensoreurope.com

System Sensor Europe (Customer Services)

Z.A. La Pièce 16
 Rolle, 1180
 Switzerland
 Tel: +41 21 695 30 00
 Email: orders@systemsensor.com
www.systemsensoreurope.com